

PART NUMBER

52508-67 52508-61
 52508-59 Rev. 7-66

INSTRUCTIONS**HARLEY-DAVIDSON**

**GENUINE PARTS
 AND ACCESSORIES**

BUDDY SEAT - SPORTSTERREMOVING SOLO SEAT

Remove saddle bar bolt nut and bolt. Remove three bolts and spacer securing seat to saddle bar. Remove two bolts securing seat post retaining plate to frame, release spring compression and remove seat springing assembly from frame seat post tubes.

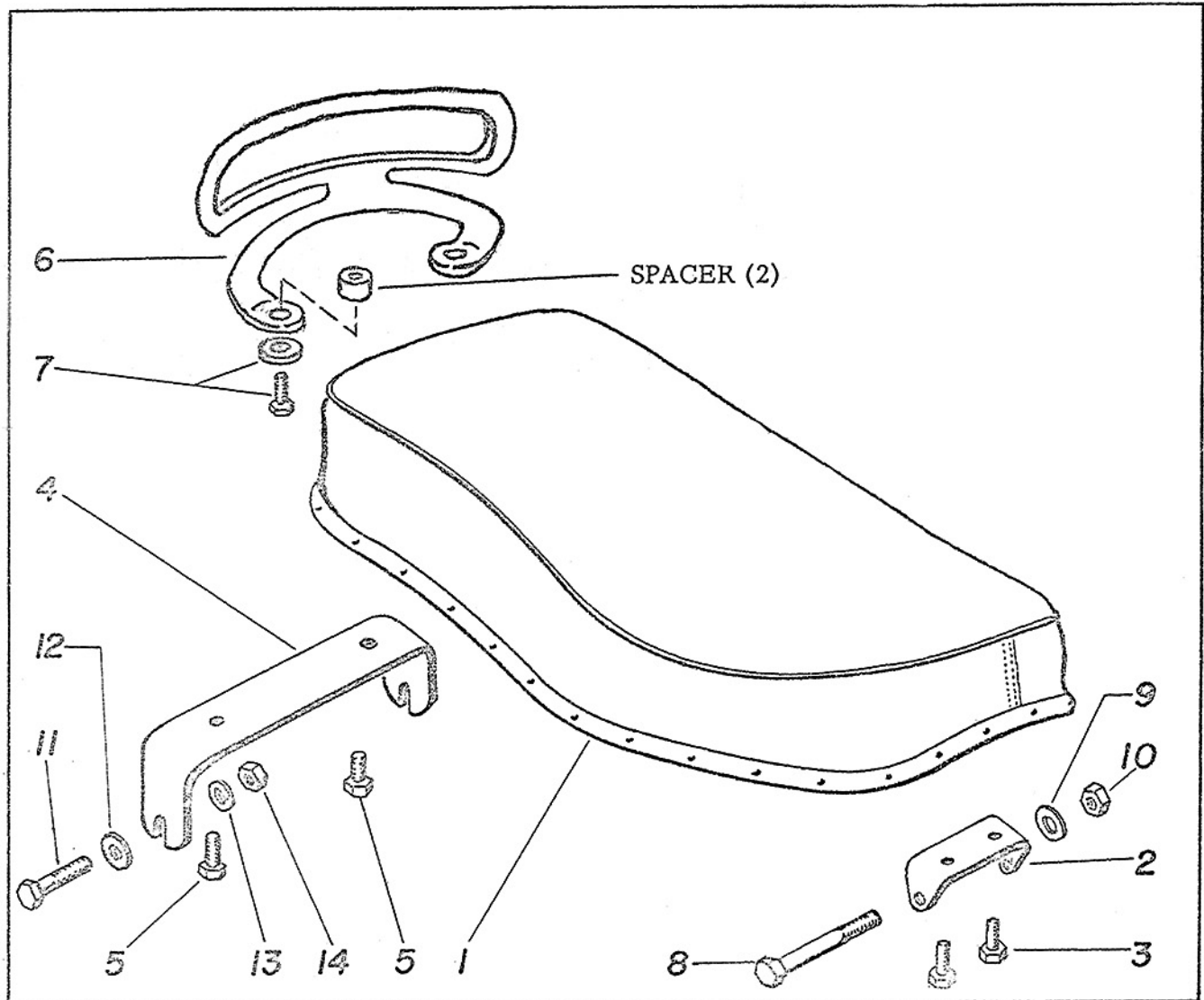
INSTALLING BUDDY SEAT

Turn buddy seat (1) upside down and position front bracket (2) so it is over two corresponding holes in seat base. Secure bracket with two 5/16 x 3/4 long bolts (3).

Position rear bracket (4) across seat base over holes approximately 12" from back edge of seat. Secure rear bracket with two 5/16 x 3/4 long bolts (5).

(OVER)

Attach seat handrail (6) with two 5/16 x 1 1/2 long bolts and plain washers (7). Use tapped holes located near back edge of seat base. Note that spacers go between handrail ear and seat base so that handrail clears base outer lip.

Install seat on chassis using 5/16 x 3-1/16 long bolt (8) to secure front bracket to frame. Use the lockwasher (9) and nut (10) previously removed. Remove center rear fender support screws (located in first hole through fender support to rear of upper shock absorber eye mounting). Slip plain washer (12) over 3/8 x 1-5/8 long bolt (11) provided in kit and assemble through fender support and fender with lockwasher (13) and nut (14) (previously removed). Lower seat and position seat rear bracket ends between plain washer and fender support. Tighten nuts (14) in back of fender support.

ATTACHING BUDDY SEAT FOOTRESTS

Remove two bolts from rear engine mount. Bolts are located in frame lower fitting, above brake cross shaft. Assemble two 3/8 x 2-1/4 bolts (with lockwashers removed from shorter bolts) through footrest support and into rear engine mount holes.

Attach left footrest (open side up) to end of footrest support with 5/16 x 1-1/2 long hexagon head bolt and self-locking nut.

Attach right footrest in similar manner using the 5/16 x 2-5/8 long stud and self-locking nut. Place straight end of footrest spring in 3/32" hole in footrest support, slip spring coil over end of footrest stud, and loop curved end of spring under footrest. Secure spring through hole in end of footrest stud with cotter pin provided. Spring tension should fold footrest to vertical position.

Harley-Davidson, Inc. has given us permission to provide this document on our website for the sole purpose of helping us restore our motorcycles.

Harley-Davidson, Inc. retains copyright over these materials, and NO reproduction or other use of these materials is permitted without prior authorization from Harley-Davidson, Inc.

The **Old Sportster and K-model Research Group (OSKRG)** is a group of individuals who have spent years researching the minute differences in the parts, fit, finish, and configuration of the Harley-Davidson 1952-1956 K-Models, and (early) 1957-1969 Sportster models.

The results of our research is published on our website
www.harleyKmodel.com